

Factory configuration



- ①pump 1pcs ②Gague1 pcs ③63Mpa spring hose 1 pcs  
④Spare parts 1 set ⑤Multifunctional wrench 1pcs  
⑥8m female quick connector 1 pcs,Car connectori pcs,testing  
Plugging head 1 pCS

Leak detection required after installation of new pump

Testing:Use the plug and plugging the pipe to inflate to 20mpa when assembled observe the pressure gague after 10s to drop.- do not drop is not leaking.If leaking,then make the pump into wa- ter,observe the location of leaking.

Silicone oil and water cooled liquid considerations

The air pump does not contain silicone oil,For air shipping sercu- rity reasons,oil can be purchased from local store,oil adding should appropriate,jif too much it is easy to plug one-way valve,water cooled liquid has been added,between 2 and 3 levels stage position,do not need add.

Low pressure on the vent when pressure down

The operating principle of the pump:puling up the second-level system,to the tertiary system pressure,the primary system intake. Because the outlet is not connected to the container,the second stage system pressure discharged directly through the third sys- tem,so the air vent volume is very smal,it is ok.

Install instruction Step diagram

Note: Parts tools



1.Instal hose



2 Do not use hand please use wrenches



3.Install the handle



4.Hex wrench,tighten the Hex wrench,tighten the

Assumption diagram

Structure

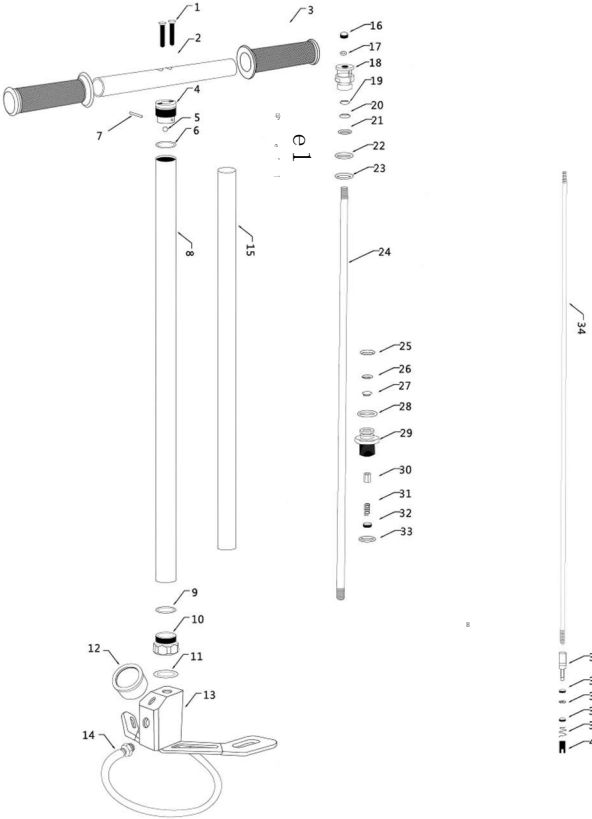

- 1 Handle screws  
3 Handle pole  
3 Handle  
4 Inlet valve  
5 Intake valve sealing ball  
6 Intake valve sealing ring  
7 Three-level bar pins  
8 First tubes (big bands)  
9 First-stage piston external seals  
10 First-stage  
11 First-stage piston seals  
12 Pressure gauge  
13 Foldable base  
14 Vent pipe  
15 Second tubes (medium)  
16 Third grade-oriented  
17 Third-level sealing ring  
18 The second-stage piston  
19 Third-bottom of the upper part of the pip seals  
20 Third grade tube top top sealing ring  
21 Third level canal upper seal ring  
22 Second-level pipe piston seals  
23 Second-level pipe piston seals  
24 Third tubes (high pressure pipes)  
25 Third-level pipe part sealing ring  
26 Third-level pipe part sealing ring  
27 Third-bottom of the lower part of the pipe seals  
28 Damping ring  
29 Main High pressure valves  
30 High pressure valves  
31 Spring  
32 The top cover  
33 Sealing ring  
34 Three-stage solid rod  
35 Three-stage piston on  
3 6 Three-stage piston ring  
37 Three-stage piston seal ring  
38 Three-stage piston brass ring  
39 Three-stage piston spring  
40 The piston screw

BalystiK  
Airsoft Parts

300 BAR 4 STAGE HAND PUMP FOR HPA TANK



The refueling  
and maintenance *Maintenance*

①Refueling

New pump,pressing after 1500 times need refueling once.One place 3 drops of oil, As shown in the following illustration,add oil pressing 50 times,drain excess oil and water.



② Female connector installation

Female connector should be properly installed,Otherwise,it is easy to jam,as shown in the left image below.

③ Pressure relief

The air pressure must be vented,as shown in the following illustration.When not in use,try to keep the pump in the pressure-free state.Hose can't bend over,don't crash pressure gauge.

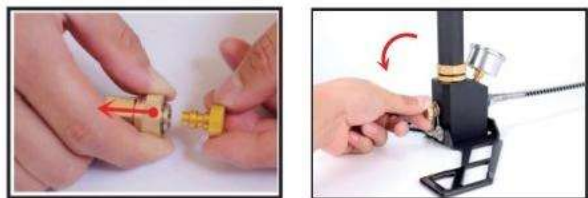

④Water Cooling Principle Description

The water of the air-cooled barrel is between the secondary and tertiary tubes.The water has already been added.Sealed inside,no need to add.water-cooled conduction heat,not refrigeration.Fever is normal,indicating that heat is discharged to continue working.

① One-way clearance

When used upward pull heavy,pressure gauge value rises when downward pressure.The pressure gauge decreases when the hand is loosened.This indicates that the one-way valve has sewage,or has been damaged.Solution:Check whether the valve sludge too much,if a serious rebound phenomenon,is a one-way valve to appear oily,or one-way valve damage.You need to clean up the one-way valve, Replace the valve seal ring or Spring



②Air Intake Clearance

Air pressure when the pump is inflated,press the hand when the vent,pulling out when not breathing.Reason:There are foreign bodies in the small holes in the middle of the hand.The intake ball cannot be returned to the sealing position.Solution:Disassemble the pump.remove the three-stage pole fixation bolt, remove the air intake ball,clean the small holes and the ball.If the ball is damaged,replace it and install it back.



③Pressure gauge damage

Pressure gauge does not return to zero:Reason:Excess oil is not cleaned.About 20mpa oil and gas produce swelling,pressure instantly reaches 40mpa,pressure gauge exceeds load and then damage.Or the pressure gauge receives a severe shock causing a shift in the pointer,which requires replacing the pressure gauge.



Importateur : Balystik  
11 rue des artisans  
31140 Pechbonnieu  
FRANCE

SKU: BA-HPA-HPUMP